



Optional 3-night Post Cruise Package in Otsu

September 26-29, 2007

Escorted by Pieter and Alida Meijers

We are pleased to offer you an exclusive extended stay in Otsu for 3 nights. Otsu is a beautiful city located on Lake Biwa, 10 minutes east of Kyoto.

Included:

- 3 nights at the Otsu Prince Hotel at Lake Biwa
- 3 breakfasts and 1 dinner
- 3 full day excursions.
- All transfers, luggage handling, portorage and admission for scheduled sightseeing

Sightseeing program* covers the following sights:

Kyoto Ancient Capital, Nijo Castle, Kinkakuji Golden Pavillion, Kiyomizu Temple, Miho Museum, Nara city, Todaiji Temple, Nara National Museum, Kasuga Shrine, Mt. Hiei, Enryakuji Temple and more.

*changes to the sightseeing program may occur without notice, all sightseeing is narrated by English-speaking guides / luxurious motor coaches.

➔Rate per person: \$ 865.- (*based on sharing*) - Check only please

Single Supplement: \$295.-

Payment by Visa, MC and Discover is possible for an additional \$ 30.- per person.

Please mail deposit of \$ 100.- per person.

For more information please contact Jazzdagen Tours at: 800 433 0078

✂-----

Reservation Form Post Cruise Package – Otsu – September 26 – 29, 2007

I am/ we are enclosing \$ 100.- per person by check.

Name(s): _____ Tel.: _____

Address: _____

City / State / Zip: _____

Please mail to: Jazzdagen Tours ♦ P.O. Box 1706 ♦ Studio City, California 91614

Fax: 323 650 0950 - email: jazzdagen@aol.com

OTSU PRINCE HOTEL



On the shores of Lake Biwa, in the heart of the Japanese archipelago, stands the 38-story Otsu Prince Hotel, one of the largest conference venues in Japan.

Each guest room offers an unparalleled view of the lake and the surrounding hills. Since it is only 10 minutes from Otsu Station to Kyoto Station, the hotel is also an ideal base for sightseeing in Shiga and Kyoto.

With its convenient location, beautiful setting and attentive service, the Otsu Prince Hotel is the perfect choice for business meetings, as well as a relaxing vacation.

Otsu Prince Hotel
7-7, Nionohama 4-chome
Otsu-shi, Shiga 520-8520
Japan

Phone: 81-77-521-1111
Fax: 81-77-521-1110

OTSU PRINCE HOTEL Guest Rooms



All rooms offer a stunning view of Lake Biwa, Japan's #1 lake for size and natural beauty.

- 540 room
- High-speed internet access provided for all rooms (1,050 yen daily)
- Room types:
 - Twin (2 beds)
 - Double (1 queen bed)

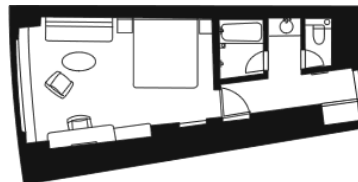

Double Room

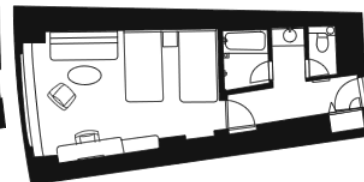

Twin Room A

- Room service available
- Hair dryer in all rooms
- Video player in all rooms
- Non-smoking floor available
- Wheelchair-accessible room available
- Three- and four-bed rooms available for families
- All Nippon Air (ANA) Mileage program accepted

OTSU PRINCE HOTEL Services & Facilities



For Your Convenience

- **Business Service Center**
 - Open Daily from 08:00 ~ 12:00 midnight
 - Located next to the Front Desk at the Lobby
 - Desk-top computer
 - High-speed internet access (500 yen per 30 minutes)
 - Fax machine
 - Copy machine
- Outdoor swimming pool (Summer only)
- 24-hour convenience shop
- Souvenir shop
- Wedding facilities - Two Shinto wedding halls, two chapels, three photo studios, two beauty salons, dressing room
- Four tennis courts - All-weather surfaces with floodlighting
- Mahjong game room
- Parking - Free for up to 928 cars

OTSU PRINCE HOTEL Restaurants



Otsu Prince Hotel offers following 8 restaurants and lounges.

- **Beaux Sejours French Restaurant** - Fine French cuisine with a panoramic view of Lake Biwa. (Lunch and Dinner)
- **Top of Otsu** - A sky lounge offering coffee and tea at lunch, cocktails in the evening.
- **Garden Restaurant** - Grand Opening June 10, 2005. New outdoor BBQ restaurant. Hours: 5:30p.m.~9:00p.m.
- **New York Steak and Seafood** - Offers delicious lunch buffets and course menus featuring seasonal specialties. (Breakfast Buffet, Lunch and Dinner)
- **Shimizu Japanese Restaurant** - Your choice of sushi or tempura a la carte at the counter or the traditional course menus, *Kaiseki*, at the tables. (Lunch and Dinner)
- **Riho Chinese Restaurant** - Four private dining rooms featuring authentic Canton-style cuisine.
- **Marmolada Coffee Shop** - Features light meals and a dinner buffet in a casual, contemporary setting.
- **Chatelaine Lobby Lounge** - A great place for meeting friends and business associates for drinks and conversation. Original blend coffee, tea, homemade cakes, and desserts. Hours: 9:00a.m.~9:00p.m.